



### IMPORTANT WARNINGS

 Before to use the tools contained in this set, please read carefully the instruction contained in this manual. Improper or unsafe use of the tools contained in this set can result in death or serious bodily injury. This manual of instructions constitutes an integral part of product and it has to be edited by the end user for every possible future consultation. It contains important informations about the safety use of the product. READ THESE INSTITUTIONS IN CONJUNCTION WITH VEHICLE MANUFACTURER MANUAL.

 ALWAYS WEAR PROPER WORK GLOVES

 ALWAYS WEAR WORK GLASSES EQUIPPED WITH SIDE PROTECTIONS

### SAFETY INSTRUCTION

- Maintain the set in good conditions. Before each use check condition of each component. If any component is damaged, replace immediately with genuine parts only. Not genuine parts may not function correctly and it will invalid the warranty.
- Keep work area free from unrelated materials and with adequate lighting.
- Keep children and unauthorised persons away from the working area.
- Do not use the tester when you are under the influence of alcohol, drugs,...
- Do not clean the parts with solvents or other harsh chemicals.
- When not in use store the complete kit in a safe, dry, childproof locations.

### DESCRIPTION & CONTENT

This universal kis is designed for quick and easy installation of the seal of crankshaft or camshaft. It contains:

- “A” Adaptors to be chosen depending on camshaft/crankshaft existing bolt: 7 pcs.
- “B” chrome spacer to match the pulley: 6 pcs.
- “C” coloured adaptors to be chosen depending on the seal diameter: 12 pcs.

A: Adaptor		B: chrome spacer	
A1	Ø 8 mm	B1	Adjustable spacer min. application lenght: 33 mm max. application lenght: 50 mm
A2	Ø 10 mm	B2	Concaved: Ø54,5 x Ø24,5
A3	Ø 12 mm	B3	Raised: Ø54,5 x Ø14,5
A4	Ø 14 mm	B4	Raised: Ø54,5 x Ø24,5
A5	Ø 16 mm	B5	Ø54,5 x Ø46 x Ø40,5 / Thickness: 15 mm
A6	Ø 18 mm	B6	Ø54,5 x Ø46 x Ø40,5 / Thickness: 23 mm
A7	Ø 20 mm		

C: Seal Adaptor	
C1	Ø 68 (silver)
C2	Ø 64 (purple)
C3	Ø 60 (sea blue)
C4	Ø 58 (golden)
C5	Ø 56 (grass green)
C6	Ø 52 (dark gray)
C7	Ø 49 (torquoise)
C8	Ø 48 (black)
C9	Ø 46 (orange)
C10	Ø 42 (red)
C11	Ø 34 (light gray)
C12	Ø 28 (brown)

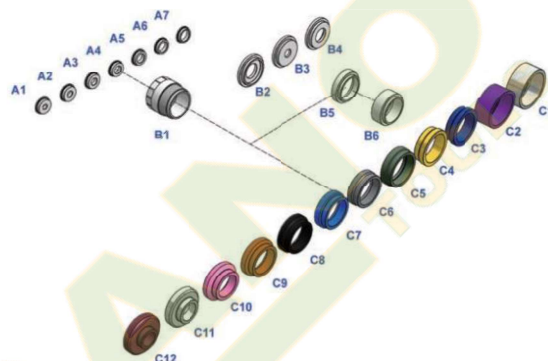

### HOW TO USE

1. Choose the “A” adaptor according to camshaft / crankshaft existing bolt diameter.
2. Choose the “B” spacer to match the camshaft / crankshaft pulley.
3. Choose the coloured “C” adaptor according to the diameter of the new seal to be installed.
4. Position the new seal manually.
5. Thread the bolt through the installer kit (A+B+C) and tighten clockwise by hand. Tighten with a spanner until the seal is fully installed.
6. Lastly turn the bolt anti-clockwise to remove the installation kit.

